



University Space Committee

Thursday, September 19, 2019

4:00pm – 5:00pm

Hinderaker 0154

<https://usc.ucr.edu/>

Call-In Number: <https://ucengage.zoom.us/j/7473353146>

1 669 900 6833 US Meeting ID: 747 335 3146

MEETING AGENDA

1. Roll call and introduction of new members
2. ACTION: CHASS request in the Arts building for a Piano Lab. This would be a space transfer from the Library.
3. INFORMATION: Student Services building. Fourteen new cubicles will become available at the end of the calendar year. AVC Enrollment Services will provide additional information on the building and sensitivities for committee consideration while making recommendations.
4. INFORMATION: Email Recommendations <ul style="list-style-type: none">○ Assign Skye 3rd floor offices to Math○ Send call letter for Student Services cubicles
5. DISCUSSION: Review Space Requests and Proposed Targets document. New/updated items: <ul style="list-style-type: none">○ CHASS request in Arts○ VCPBA request in Intellicenter for R'SSC○ Update on Visualization Lab
6. INFORMATION: Temporary space assignments Pierce 2100/A; Physics 2144
Anticipated Future Items: <ul style="list-style-type: none">● Request for cubicles in Intellicenter (R'SSC and SOM)● Discussion – how are graduate student spaces assigned in the Colleges?
Meeting Materials:

Committee Staff Contacts:

Sharyl Murdock, Campus Space Manager; 951-827-2126; or Sharyl.murdock@ucr.edu

Space Request Music - Arts building floorplan Review

8.30.19 Email Recommendations

Space Requests and Proposed Targets document

Temporary space assignment floorplans

CHASS Space Request Music Arts Basement

Room	ASF	GSF
0053	181	278
0054	2,123	3,266
Total	2,304	3,545

This space is currently assigned to the Library and has been used as a Music Library. Library is releasing the space to allow CHASS to use it for priority space needs. CHASS intends to use the space as a Piano Lab for faculty and students if assigned. The majority of the building is assigned to CHASS departments.



Sharyl Murdock

From: Sharyl Murdock
Sent: Friday, August 30, 2019 2:56 PM
To: Provost; Gerry Bomotti (gerard.bomotti@ucr.edu); Cathy Eckman; Georgianne Carlson; Jose Wudka; Maggie Souder (msouder@enr.ucr.edu); Susan Marshburn (susan.marshburn@ucr.edu); Veronica Ruiz; Gillian Wilson; Deborah H McWilliams; Rodolfo Humberto Torres; janew@ucr.edu
Cc: Provostadmin; Elizabeth Perez; VCREDadmin
Subject: USC - committee input requested
Attachments: Skye VCSA spaces.pdf

Committee Members,

There are two groups of space anticipated to become available at the end of this calendar year that have been discussed at previous meetings. We are looking for your input on the most appropriate process to review requests for these spaces. We think these process recommendations can be handled via email however we can wait for the next meeting if there are concerns that should be discussed further in person. Please provide your feedback on the two items below by September 13th.

1. Skye 3rd floor private offices – as noted in the May Space Call Letter, there will be 6 private offices on the 3rd floor of Skye coming available at the end of this year. As previously discussed there are many space needs across campus however we are recommending to the USC that the space be assigned to Math for the reasons noted below. Additional options are to consider other requests already on our Space Requests and Proposed Targets list or to send another Call Letter for this space. A floorplan is attached for reference.
 - a. Provost Larive believed that Math required more faculty and approved 5 new faculty hires that will arrive on 7/1/20. Math does not currently have available offices for these positions and has previously requested space.
 - b. The new VCRed and spousal hire were unanticipated new Math faculty requiring additional academic offices.
 - c. Math already occupies space on the 2nd and 3rd floors of Skye, so space on the 3rd floor would be a good adjacency for them.
 - d. Note: the request is for 7 offices however only 6 will be available.
 2. Student Services building additional cubicles – we anticipate adding 6 new cubicles to the 2nd floor and 8 new cubicles to the 3rd floor. We anticipate these new cubicles will be installed in the December, 2019, timeframe. The layout of these floors is mostly open workstations with a few private offices. Due to the sensitive nature of some of the activities on the 2nd floor (including Financial Aid and Registration) we are recommending that space stay assigned to Enrollment Management for future growth. We recommend we provide an administrative recommendation for the allocation of the 3rd floor cubicles based on requests already in the target listing. However, we could also send another Call Letter out for this space.
 - a. We plan to invite LaRae Lundgren, AVC of Enrollment Management, to speak at the next USC meeting about existing activities in the building so the Committee can recommend functions that will have the best synergies. We will also provide more information on the layout of the space for reference.
- For Skye 3rd floor should we move forward with the Math recommendation, review the existing request list, or send another Call Letter?
 - For Student Services cubicles should we review the existing request list or send another Call Letter?

If the recommendations are to send another Call Letter to campus we will start that process.

Student Services Building – 2nd floor New Cubicle Installation Area

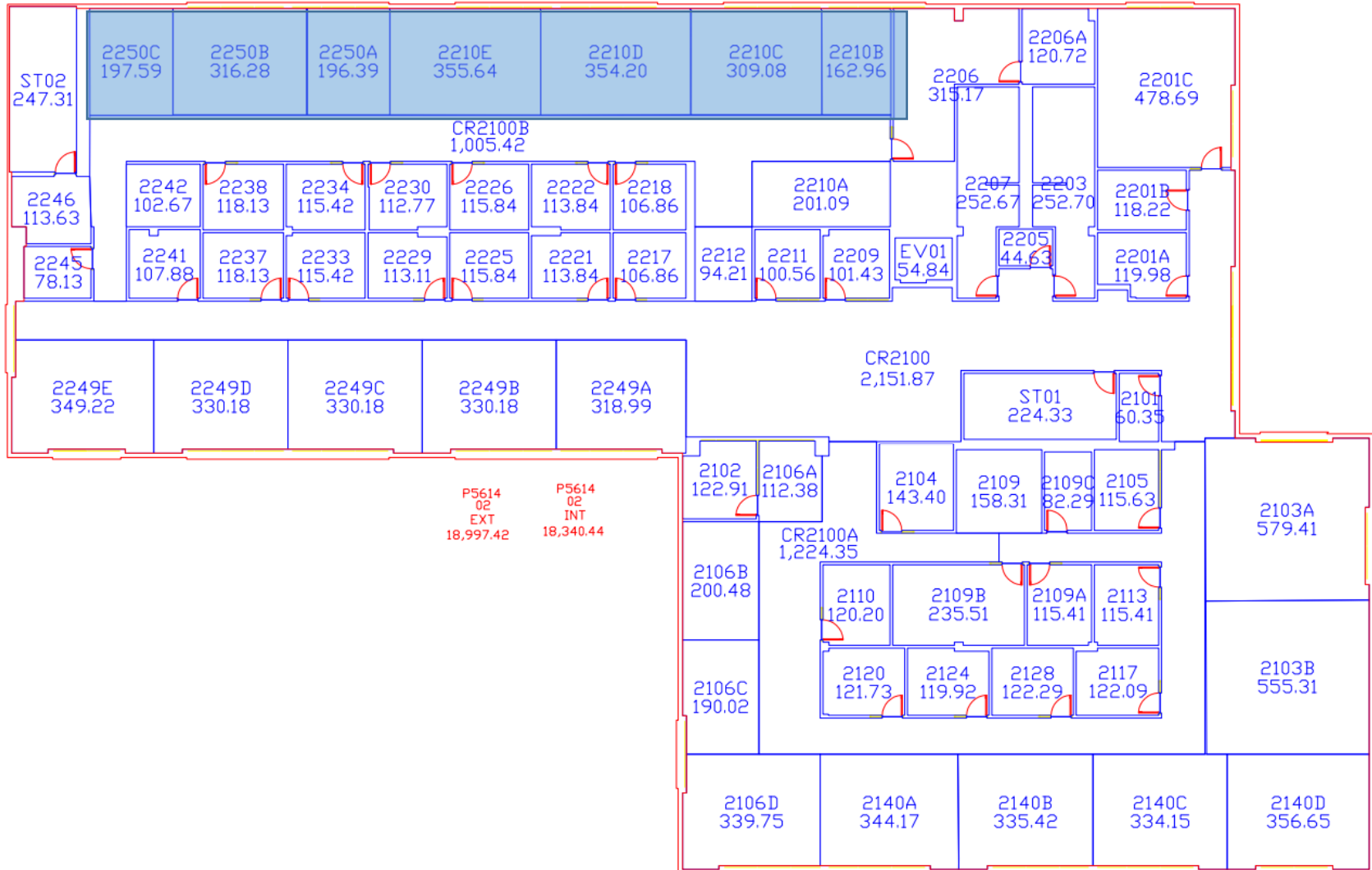

Student Services Building – 3rd floor New Cubicle Installation Area

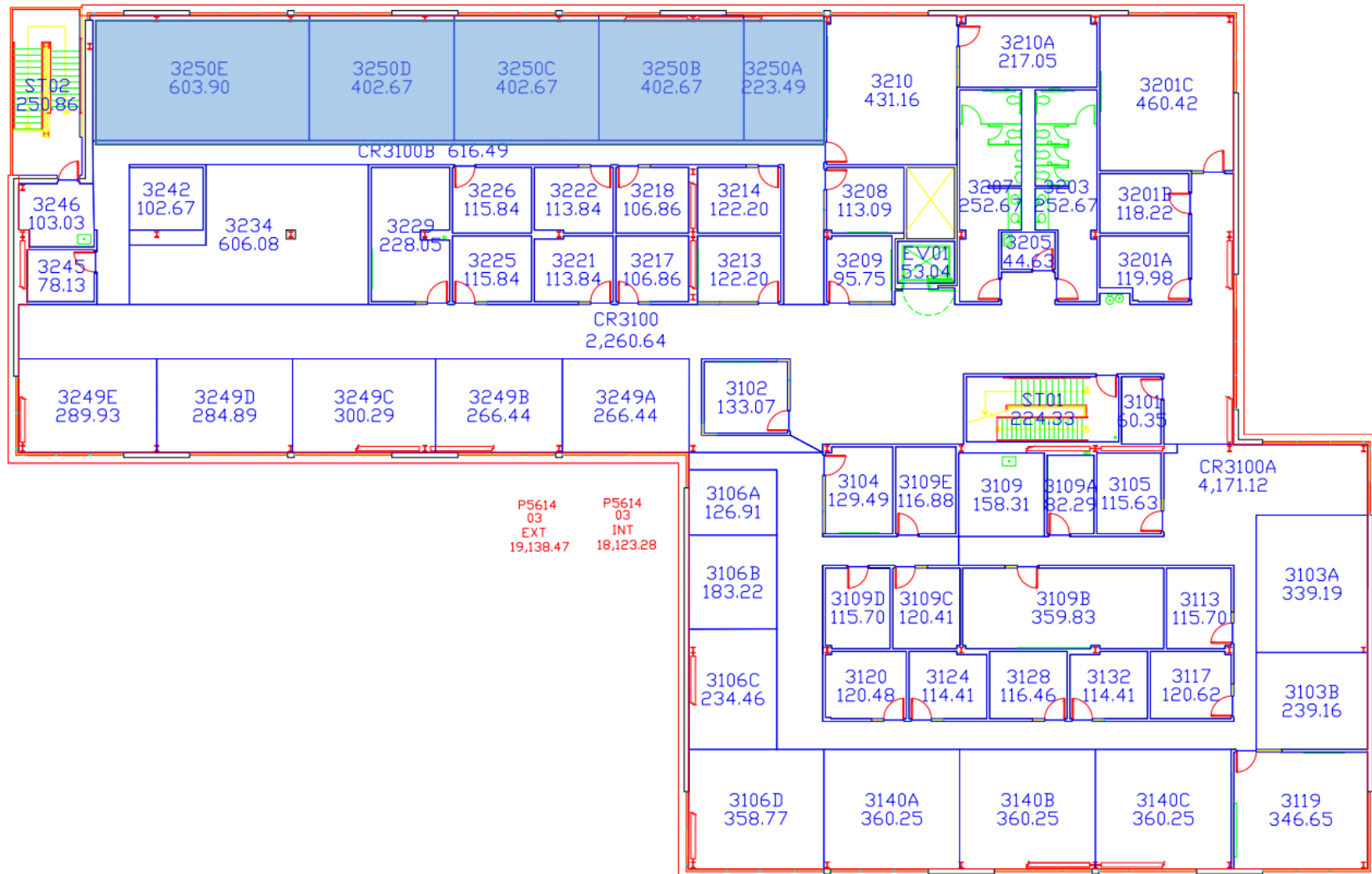

Campus Space Requests and Proposed Targets - Updated 9/12/19

Target	Requirements / Notes	Date Requested	Status
VCPBA / R'Shared Service Center	BAS is requesting additional space in the Intellicenter for approved new hires.	9/12/2019	New request. More information will be provided for the November 2019 meeting.
CHASS / Music	CHASS is requesting Arts 0053/0054. This space was a Music Library but the items are now being moved to the main Library in order to accommodate CHASS space needs. CHASS is requesting the space be assigned to them for a Piano Lab.	9/9/2019	New request. Space Management recommends this assignment.
Visualization Lab (Mobasher)	1,000 ASF for research, training, instruction and outreach. Unrestricted access, preferably close to the center of campus in a visible location. Newer infrastructure that can accommodate state of the art technology. Networked security cameras. Operating schedule 8-5 for training, instruction, outreach and 24/7 in support of research. Would be looking for grants to maintain and upgrade the space. Intended users: all colleges and centers, outreach programs, interdisciplinary online teaching. Supported through ITS with program development provided by research and academic programs. Requestor recommended spaces: Skye 0170, 0171, 0172 or 0173, CHASS Int South 1121 or 2138, CHASS Int North 1006. May not be feasible to take a general assignment classroom offline as requested.	9/24/2018	On hold. September 2019 update - CNAS and ITS working on a MoU for a campus Visualization lab. Tentative locations will be proposed to the USC for discussion when identified.
Athletics Department	Athletics would like a space to use as a study hall since the one that is being utilized right now is for about 34 students and they have around 300 student athletes. They are requesting to have a space that increases their capacity from 34 seats to about 55-60 seats.	6/23/2019	On hold
SOM / Academic Affairs, Clinical Faculty & Clinical Finance, SOM IT	SOM would like to request additional space at PATH and Webber Hall. We've fill up the initial 5 offices and 10 cubicles at Path. However, we need additional space asap for Academic Affairs and additional Clinical Faculty and Finance staff.	6/25/2019	On hold
CHASS / Psychology	Laboratory - Changes in research -- Need dry lab for Social Psychology in the department of Sociology. Occupant of Space: Rengin Farat	6/25/2019	On hold
CHASS / Latin American Studies	Other Research Office -Space needed for Center for Latin American Studies. Occupant of Space: Alfonso Gonzales	6/25/2019	On hold
CHASS / Center for Global Studies	Other Research Office - Space needed for the Center for Global Studies. Occupant of Space: Bronwyn Anne Leebaw	6/25/2019	On hold
CHASS / Political Science	Faculty Office - Need space for faculty offices to accommodate growth in the departments. Space needed: ASAP	6/25/2019	On hold
VCSA business operations unit	Requesting Hinderaker 2117 (or other nearby office) if space becomes available to accommodate a new AVC/Dean of Students arriving August 1, 2019.	5/30/2019	On hold
Additional cubicles in Student Services building	Confirming plans to add up to 14 new cubicles in the Student Services building (6 on the 2nd floor and 8 on the 3rd floor) in order to provide additional capacity. It is currently anticipated that the 2nd floor cubicles will be used to accommodate Enrollment Services staff growth.	n/a	Information item only
Office of Sustainability	Requesting space in Student Services building to co-locate the group (currently on 3 floors of Hinderaker). Requesting 1 private office already assigned to VCPBA, a staff cubicle, and student work space for 4-6 students and some storage.	5/7/2019	Will bring request to the committee once additional capacity is confirmed.
Math growth space in Skye	Math is requesting 6 additional offices in Skye for faculty growth in FY 2019-20. Most Math space is located on the 2nd floor of Skye.	8/1/2019	Request for an additional office in Skye for Math to accommodate new VCRED faculty office
Compliance offices in Skye	Campus is transferring positions from HR to Compliance and they are requesting to co-locate the staff with other Compliance staff in Skye. They are looking for 3 private offices.	4/9/2019	On hold

Campus Space Requests and Proposed Targets - Updated 9/12/19

Target	Requirements / Notes	Date Requested	Status
Batchelor Hall	Space to accommodate 1/4 of the building in phases over a 2 year period (through 2022)	n/a	Information item only
NIH grant in Webber	Request to move forward with NIH construction grant submittal for the 2nd floor of Webber (SOM and BCOE collaboration). The request was approved by the Provost and If the grant is awarded, the space will be reassigned for this purpose. If not, the space will be available through the call letter process. Per David Lo, this will be reviewed June 26th and a few days later we should have a sense of where we stand. Actual approval would not be granted for several months.	2/7/2019	On hold. The grant was not approved for this year and will be resubmitted next year.
Shared human research studies space	Anticipated by departments as core space; large conference room; hoteling desks; various sizes testing rooms; 2,500 - 3,000 total asf; waiting area; office for staff. This was requested by a faculty member but there is not currently a plan to support this request.	11/15/2018	On hold
Released space in Bookstore	Space released by the Math Emporium is anticipated to accommodate Printing from the Printing trailer. The trailer needs to be moved by May 2021 as part of the Pierce project.	n/a	Information item only. This is not core space.
Business in Chapman	Need to match design/function of the buildings with users. Chapman may not appropriately accommodate wet lab research as currently assigned.	n/a	On hold
Relocate Chapman, Boyden, SPI faculty	Anticipate some reassignments from MRB and/or SOMR 1st floor released space	n/a	On hold
Reuse of Olmsted (Business released space)	If Olmsted is assigned space in Chapman, it is anticipated there would be released space in Olmsted to be reassigned	n/a	On hold

Campus Available /Anticipated Available Space - updated August 8, 2019

Building	Room(s)	ASF	GSF	Space Type - Current Use	Space Type - Design	Estimated Timeline	Current Occupant or Project providing released space	Temporary Use	Potential Long-Term Use	Condition
BIOLOGIC SCI	1107	125	192	ACAD OFF FACULTY		Winter 2020	Molecular, Cell & Systems Bio	Batchelor Hall		
BIOLOGIC SCI	1205	104	161	RSCH LABSV		Winter 2020	Molecular, Cell & Systems Bio	Batchelor Hall		
BIOLOGIC SCI	1205A	104	160	OCV		Winter 2020	Molecular, Cell & Systems Bio	Batchelor Hall		
BIOLOGIC SCI	1207	103	158	RSCH LABSV WET		Winter 2020	Molecular, Cell & Systems Bio	Batchelor Hall		
BIOLOGIC SCI	1215	105	162	RSCH LABSV WET		Winter 2020	Molecular, Cell & Systems Bio	Batchelor Hall		
BIOLOGIC SCI	2220	676	1,040	RESEARCH WET		Spring 2019	Molecular, Cell & Systems Bio	Batchelor Hall		
	TOTAL ASF	1,217	1,873							
CHEMICAL SCI	0221	667	1,026	RESEARCH WET		Winter 2020	CHEMISTRY	BATCHELOR HALL		
CHEMICAL SCI	0221A	326	502	RESEARCH DRY		Winter 2020	CHEMISTRY	BATCHELOR HALL		
CHEMICAL SCI	0223	668	1,028	RESEARCH WET		Winter 2020	CHEMISTRY	BATCHELOR HALL		
CHEMICAL SCI	0305	994	1,529	RESEARCH WET		Winter 2020	CHEMISTRY	BATCHELOR HALL		
CHEMICAL SCI	0339 OR 0347	996	1,532	RESEARCH WET		Winter 2020	CHEMISTRY	BATCHELOR HALL		
	TOTAL ASF	3,651	5,617							
GENOMICS	1207A	192	295	RESRCH OFC GRAD STUD		Summer 2019	Molecular, Cell & Systems Bio	Batchelor Hall	Potential use for IIGB new hire	
GENOMICS	1207H	141	217	OTHER OFF - HOTEL		Summer 2019	Molecular, Cell & Systems Bio	Batchelor Hall	Potential use for IIGB new hire	
GENOMICS	2112A	102	157	RSCH LABSV CONTROL TEMP		Spring 2019	Molecular, Cell & Systems Bio	Batchelor Hall	Potential use for IIGB new hire	
GENOMICS	2120	187	288	RSCH LABSV		Spring 2019	Molecular, Cell & Systems Bio	Batchelor Hall	Potential use for IIGB new hire	
GENOMICS	2120A	203	312	RSCH LABSV CONTROL TEMP		Spring 2019	Molecular, Cell & Systems Bio	Batchelor Hall	Potential use for IIGB new hire	
GENOMICS	2120B	137	211	RSCH LABSV CONTROL TEMP		Spring 2019	Molecular, Cell & Systems Bio	Batchelor Hall	Potential use for IIGB new hire	
GENOMICS	2121	168	258	OFFICE SRV INT HALLWAY		Spring 2019	Molecular, Cell & Systems Bio	Batchelor Hall	Potential use for IIGB new hire	
GENOMICS	2121B	171	263	ACAD OFF FACULTY		Spring 2019	Molecular, Cell & Systems Bio	Batchelor Hall	Potential use for IIGB new hire	
GENOMICS	2122	100	154	RSCH LABSV WET		Spring 2019	Molecular, Cell & Systems Bio	Batchelor Hall	Potential use for IIGB new hire	
GENOMICS	2124	94	145	RSCH LABSV WET		Spring 2019	Molecular, Cell & Systems Bio	Batchelor Hall	Potential use for IIGB new hire	
GENOMICS	2126	3,183	4,897	RESEARCH WET		Spring 2019	Molecular, Cell & Systems Bio	Batchelor Hall	Potential use for IIGB new hire	
	TOTAL ASF	4,678	7,197							
Life Science	0438	586	902	RESEARCH WET		Winter 2020	Psychology	Batchelor Hall		
Pierce	3424	702	1,080	ALTERATION		Winter 2020	Pierce Hall Renovation, Ph 1		RESEARCH WET	
Pierce	3424A	141	217	ALTERATION		Winter 2020	Pierce Hall Renovation, Ph 1		RSCH LABSV	
Pierce	3428	122	188	ALTERATION		Winter 2020	Pierce Hall Renovation, Ph 1		ACAD OFF FACULTY	
	TOTAL ASF	965	1,485							
Skye	0382, 0384, 0386	417	642	OTHER OFF		tbd VCSA	CARE		Math; VCSA Business Operations; Compliance	
Skye	0366, 0368, 0374	417	642	STUDY SERV / OTHER OFF		tbd VCSA	SDRC testing		Math; VCSA Business Operations; Compliance	
	TOTAL ASF	834	1,283							
WEBBER	1235	38	58	RSCH LABSV		Spring 2019	SOM	Batchelor Hall	Chapman/Boyden/SPI	
WEBBER	1235A	112	172	RSCH LABSV WET		Spring 2019	SOM	Batchelor Hall	Chapman/Boyden/SPI	
WEBBER	1237	154	237	ACAD OFF FACULTY		Spring 2019	SOM	Batchelor Hall	Chapman/Boyden/SPI	
WEBBER	1248	677	1,042	RESEARCH WET		Spring 2019	SOM	Batchelor Hall	Chapman/Boyden/SPI	
WEBBER	1252	319	491	RSCH LABSV WET		Spring 2019	SOM	Batchelor Hall	Chapman/Boyden/SPI	
WEBBER	1254	249	383	OTHER OFF		Spring 2019	SOM	Batchelor Hall	Chapman/Boyden/SPI	
WEBBER	1317	1053	1,619	RESEARCH WET		Spring 2019	SOM	Batchelor Hall	Chapman/Boyden/SPI	
WEBBER	1317A	38	58	RSCH LABSV EQUIPMENT		Spring 2019	SOM	Batchelor Hall	Chapman/Boyden/SPI	
WEBBER	1317B	124	191	RSCH LABSV WET		Spring 2019	SOM	Batchelor Hall	Chapman/Boyden/SPI	
WEBBER	1317C	81	125	RSCH LABSV DARK ROOM		Spring 2019	SOM	Batchelor Hall	Chapman/Boyden/SPI	
Webber	2101	617	949	RSCH LABSV WET		Available	SOM	Batchelor Hall	Potential NIH grant or Chapman/Boyden/SPI relocations	
Webber	2101A	162	249	RESRCH OFC RESEARCH STAFF		Available	SOM	Batchelor Hall	Potential NIH grant or Chapman/Boyden/SPI relocations	
Webber	2101B	163	250	RSCH LABSV WET		Available	SOM	Batchelor Hall	Potential NIH grant or Chapman/Boyden/SPI relocations	
Webber	2101C	340	523	RESEARCH WET		Available	SOM	Batchelor Hall	Potential NIH grant or Chapman/Boyden/SPI relocations	
Webber	2139	223	342	RESEARCH INSTRUMENT		Available	SOM	Batchelor Hall	Potential NIH grant or Chapman/Boyden/SPI relocations	

Campus Available /Anticipated Available Space - updated August 8, 2019

Building	Room(s)	ASF	GSF	Space Type - Current Use	Space Type - Design	Estimated Timeline	Current Occupant or Project providing released space	Temporary Use	Potential Long-Term Use	Condition
Webber	2140	567	872	RESEARCH		Available	SOM	Batchelor Hall	Potential NIH grant or Chapman/Boyden/SPI relocations	
Webber	2146	153	235	ACAD OFF FACULTY		Available	SOM	Batchelor Hall	Potential NIH grant or Chapman/Boyden/SPI relocations	
Webber	2219	184	283	RESEARCH WET		Available	SOM	Batchelor Hall	Potential NIH grant or Chapman/Boyden/SPI relocations	
Webber	2226	465	715	RESEARCH WET		Available	SOM	Batchelor Hall	Potential NIH grant or Chapman/Boyden/SPI relocations	
Webber	2226A	145	223	ACAD OFF FACULTY		Available	SOM	Batchelor Hall	Potential NIH grant or Chapman/Boyden/SPI relocations	
WEBBER	2231	226	348	RESEARCH WET		Spring 2019	SOM	Batchelor Hall	Potential NIH grant or Chapman/Boyden/SPI relocations	
Webber	2235	158	243	RSCH LABSV		Available	SOM	Batchelor Hall	Potential NIH grant or Chapman/Boyden/SPI relocations	
WEBBER	2241	144	222	RESEARCH INSTRUMENT		Spring 2019	SOM	Batchelor Hall	Potential NIH grant or Chapman/Boyden/SPI relocations	
WEBBER	2245	39	60	RESEARCH INSTRUMENT		Spring 2019	SOM	Batchelor Hall	Potential NIH grant or Chapman/Boyden/SPI relocations	
WEBBER	2245A	111	171	RESEARCH INSTRUMENT		Spring 2019	SOM	Batchelor Hall	Potential NIH grant or Chapman/Boyden/SPI relocations	
WEBBER	2247	152	234	RSCH LABSV WET		Spring 2019	SOM	Batchelor Hall	Potential NIH grant or Chapman/Boyden/SPI relocations	
WEBBER	2263	449	691	RESEARCH WET		Spring 2019	SOM	Batchelor Hall	Potential NIH grant or Chapman/Boyden/SPI relocations	
WEBBER	2269	154	236	ACAD OFF FACULTY		Spring 2019	SOM	Batchelor Hall	Potential NIH grant or Chapman/Boyden/SPI relocations	
WEBBER	3220	2332	3,588	RESEARCH		Spring 2019	Microbiology & Plant Pathology	Batchelor Hall	Chapman/Boyden/SPI	
WEBBER	3263	133	204	ACAD OFF FACULTY		Spring 2019	Microbiology & Plant Pathology	Batchelor Hall	Chapman/Boyden/SPI	
	TOTAL ASF	9,758	15,012							
	GRAND TOTAL	21,689	33,368							

Campus Available /Anticipated Available Space - updated August 8, 2019

Building	Room(s)	ASF	GSF	Space Type - Current Use	Space Type - Design	Estimated Timeline	Current Occupant or Project providing released space	Temporary Use	Potential Long-Term Use	Condition
BIOLOGIC SCI	1107	125	192	ACAD OFF FACULTY		Winter 2020	Molecular, Cell & Systems Bio	Batchelor Hall		
GENOMICS	2121B	171	263	ACAD OFF FACULTY		Spring 2019	Molecular, Cell & Systems Bio	Batchelor Hall	Potential use for IIGB new hire	
WEBBER	1237	154	237	ACAD OFF FACULTY		Spring 2019	SOM	Batchelor Hall	Chapman/Boyden/SPI	
Webber	2146	153	235	ACAD OFF FACULTY		Available	SOM	Batchelor Hall	Potential NIH grant or Chapman/Boyden/SPI relocations	
Webber	2226A	145	223	ACAD OFF FACULTY		Available	SOM	Batchelor Hall	Potential NIH grant or Chapman/Boyden/SPI relocations	
WEBBER	2269	154	236	ACAD OFF FACULTY		Spring 2019	SOM	Batchelor Hall	Potential NIH grant or Chapman/Boyden/SPI relocations	
WEBBER	3263	133	204	ACAD OFF FACULTY		Spring 2019	Microbiology & Plant Pathology	Batchelor Hall	Chapman/Boyden/SPI	
Pierce	3424	702	1,080	ALTERATION		Winter 2020	Pierce Hall Renovation, Ph 1		RESEARCH WET	
Pierce	3424A	141	217	ALTERATION		Winter 2020	Pierce Hall Renovation, Ph 1		RSCH LABSV	
Pierce	3428	122	188	ALTERATION		Winter 2020	Pierce Hall Renovation, Ph 1		ACAD OFF FACULTY	
BIOLOGIC SCI	1205A	104	160	OCV		Winter 2020	Molecular, Cell & Systems Bio	Batchelor Hall		
GENOMICS	2121	168	258	OFFICE SRV INT HALLWAY		Spring 2019	Molecular, Cell & Systems Bio	Batchelor Hall	Potential use for IIGB new hire	
Skye	0382, 0384, 0386	417	642	OTHER OFF		tbd VCSA	CARE		Math; VCSA Business Operations; Compliance	
WEBBER	1254	249	383	OTHER OFF		Spring 2019	SOM	Batchelor Hall	Chapman/Boyden/SPI	
GENOMICS	1207H	141	217	OTHER OFF - HOTEL		Summer 2019	Molecular, Cell & Systems Bio	Batchelor Hall	Potential use for IIGB new hire	
Webber	2140	567	872	RESEARCH		Available	SOM	Batchelor Hall	Potential NIH grant or Chapman/Boyden/SPI relocations	
WEBBER	3220	2332	3,588	RESEARCH		Spring 2019	Microbiology & Plant Pathology	Batchelor Hall	Chapman/Boyden/SPI	
CHEMICAL SCI	0221A	326	502	RESEARCH DRY		Winter 2020	CHEMISTRY	BATCHELOR HALL		
Webber	2139	223	342	RESEARCH INSTRUMENT		Available	SOM	Batchelor Hall	Potential NIH grant or Chapman/Boyden/SPI relocations	
WEBBER	2241	144	222	RESEARCH INSTRUMENT		Spring 2019	SOM	Batchelor Hall	Potential NIH grant or Chapman/Boyden/SPI relocations	
WEBBER	2245	39	60	RESEARCH INSTRUMENT		Spring 2019	SOM	Batchelor Hall	Potential NIH grant or Chapman/Boyden/SPI relocations	
WEBBER	2245A	111	171	RESEARCH INSTRUMENT		Spring 2019	SOM	Batchelor Hall	Potential NIH grant or Chapman/Boyden/SPI relocations	
BIOLOGIC SCI	2220	676	1,040	RESEARCH WET		Spring 2019	Molecular, Cell & Systems Bio	Batchelor Hall		
CHEMICAL SCI	0221	667	1,026	RESEARCH WET		Winter 2020	CHEMISTRY	BATCHELOR HALL		
CHEMICAL SCI	0223	668	1,028	RESEARCH WET		Winter 2020	CHEMISTRY	BATCHELOR HALL		
CHEMICAL SCI	0305	994	1,529	RESEARCH WET		Winter 2020	CHEMISTRY	BATCHELOR HALL		
CHEMICAL SCI	0339 OR 0347	996	1,532	RESEARCH WET		Winter 2020	CHEMISTRY	BATCHELOR HALL		
GENOMICS	2126	3,183	4,897	RESEARCH WET		Spring 2019	Molecular, Cell & Systems Bio	Batchelor Hall	Potential use for IIGB new hire	
Life Science	0438	586	902	RESEARCH WET		Winter 2020	Psychology	Batchelor Hall		
WEBBER	1248	677	1,042	RESEARCH WET		Spring 2019	SOM	Batchelor Hall	Chapman/Boyden/SPI	
WEBBER	1317	1053	1,619	RESEARCH WET		Spring 2019	SOM	Batchelor Hall	Chapman/Boyden/SPI	
Webber	2101C	340	523	RESEARCH WET		Available	SOM	Batchelor Hall	Potential NIH grant or Chapman/Boyden/SPI relocations	
Webber	2219	184	283	RESEARCH WET		Available	SOM	Batchelor Hall	Potential NIH grant or Chapman/Boyden/SPI relocations	
Webber	2226	465	715	RESEARCH WET		Available	SOM	Batchelor Hall	Potential NIH grant or Chapman/Boyden/SPI relocations	
WEBBER	2231	226	348	RESEARCH WET		Spring 2019	SOM	Batchelor Hall	Potential NIH grant or Chapman/Boyden/SPI relocations	
WEBBER	2263	449	691	RESEARCH WET		Spring 2019	SOM	Batchelor Hall	Potential NIH grant or Chapman/Boyden/SPI relocations	
GENOMICS	1207A	192	295	RESRCH OFC GRAD STUD		Summer 2019	Molecular, Cell & Systems Bio	Batchelor Hall	Potential use for IIGB new hire	
Webber	2101A	162	249	RESRCH OFC RESEARCH STAFF		Available	SOM	Batchelor Hall	Potential NIH grant or Chapman/Boyden/SPI relocations	
BIOLOGIC SCI	1205	104	161	RSCH LABSV		Winter 2020	Molecular, Cell & Systems Bio	Batchelor Hall		
GENOMICS	2120	187	288	RSCH LABSV		Spring 2019	Molecular, Cell & Systems Bio	Batchelor Hall	Potential use for IIGB new hire	
WEBBER	1235	38	58	RSCH LABSV		Spring 2019	SOM	Batchelor Hall	Chapman/Boyden/SPI	
Webber	2235	158	243	RSCH LABSV		Available	SOM	Batchelor Hall	Potential NIH grant or Chapman/Boyden/SPI relocations	
GENOMICS	2112A	102	157	RSCH LABSV CONTROL TEMP		Spring 2019	Molecular, Cell & Systems Bio	Batchelor Hall	Potential use for IIGB new hire	
GENOMICS	2120A	203	312	RSCH LABSV CONTROL TEMP		Spring 2019	Molecular, Cell & Systems Bio	Batchelor Hall	Potential use for IIGB new hire	
GENOMICS	2120B	137	211	RSCH LABSV CONTROL TEMP		Spring 2019	Molecular, Cell & Systems Bio	Batchelor Hall	Potential use for IIGB new hire	
WEBBER	1317C	81	125	RSCH LABSV DARK ROOM		Spring 2019	SOM	Batchelor Hall	Chapman/Boyden/SPI	
WEBBER	1317A	38	58	RSCH LABSV EQUIPMENT		Spring 2019	SOM	Batchelor Hall	Chapman/Boyden/SPI	
BIOLOGIC SCI	1207	103	158	RSCH LABSV WET		Winter 2020	Molecular, Cell & Systems Bio	Batchelor Hall		
BIOLOGIC SCI	1215	105	162	RSCH LABSV WET		Winter 2020	Molecular, Cell & Systems Bio	Batchelor Hall		
GENOMICS	2122	100	154	RSCH LABSV WET		Spring 2019	Molecular, Cell & Systems Bio	Batchelor Hall	Potential use for IIGB new hire	
GENOMICS	2124	94	145	RSCH LABSV WET		Spring 2019	Molecular, Cell & Systems Bio	Batchelor Hall	Potential use for IIGB new hire	
WEBBER	1235A	112	172	RSCH LABSV WET		Spring 2019	SOM	Batchelor Hall	Chapman/Boyden/SPI	
WEBBER	1252	319	491	RSCH LABSV WET		Spring 2019	SOM	Batchelor Hall	Chapman/Boyden/SPI	
WEBBER	1317B	124	191	RSCH LABSV WET		Spring 2019	SOM	Batchelor Hall	Chapman/Boyden/SPI	

Campus Available /Anticipated Available Space - updated August 8, 2019

Building	Room(s)	ASF	GSF	Space Type - Current Use	Space Type - Design	Estimated Timeline	Current Occupant or Project providing released space	Temporary Use	Potential Long-Term Use	Condition
Webber	2101	617	949	RSCH LABSV WET		Available	SOM	Batchelor Hall	Potential NIH grant or Chapman/Boyden/SPI relocations	
Webber	2101B	163	250	RSCH LABSV WET		Available	SOM	Batchelor Hall	Potential NIH grant or Chapman/Boyden/SPI relocations	
WEBBER	2247	152	234	RSCH LABSV WET		Spring 2019	SOM	Batchelor Hall	Potential NIH grant or Chapman/Boyden/SPI relocations	
Skye	0366, 0368, 0374	417	642	STUDY SERV / OTHER OFF		tbd VCSA	SDRC testing		Math; VCSA Business Operations; Compliance	
	GRAND TOTAL	21,689	33,368							

Approved Temporary Space Assignments

