



## University Space Committee

Thursday, February 20, 2020

4:00pm – 5:00pm

Hinderaker 0154

<https://usc.ucr.edu/>

Call-In Number: <https://ucengage.zoom.us/j/7473353146>

1 669 900 6833 US Meeting ID: 747 335 3146

### MEETING AGENDA

1. Space request: Olmsted 2319, 2320, 2321, 2322
  - Business requesting rooms currently assigned to CHASS
2. Review Space Requests and Proposed Targets document
3. Information item: Budget Process call letter
  - In April 2019, the USC recommended that anticipated space issues be identified in the annual budget call letter. This is now included in the documentation.
4. Space report – Fall 2019

#### Meeting Materials:

Space request: Olmsted

Space Requests and Proposed Targets document

Sample Budget Process call letter – space issues

Space report link <https://usc.ucr.edu/sites/g/files/rcwecm1446/files/2020-01/CORE%20CAMPUS%20SPACE%20SUMMARY%20FALL2019.pdf>

Committee Staff Contacts:

Sharyl Murdock, Campus Space Manager; 951-827-2126; or [Sharyl.murdock@ucr.edu](mailto:Sharyl.murdock@ucr.edu)

## Business Request in Olmsted

These spaces are currently assigned to multiple CHASS departments. The surrounding space on the floor is assigned to Business.

Room	ASF	GSF
2319	125	209
2320	123	206
2321	124	207
2322	118	197
<b>Total</b>	<b>491</b>	<b>819</b>

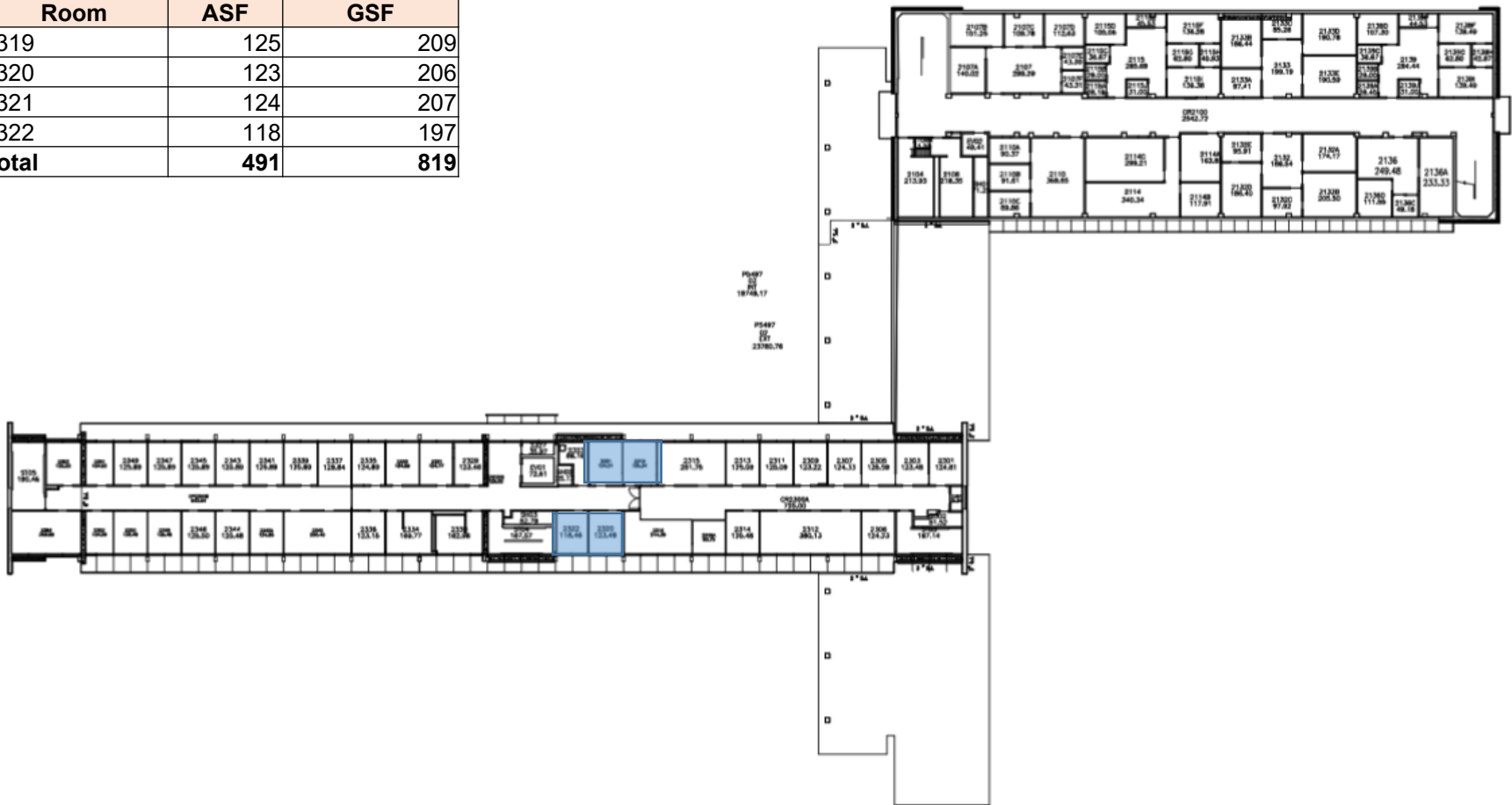

## **Business Request Justification**

Request four office spaces in Olmsted Hall - rooms 2319, 2319, 2320 and 2322. Due to new faculty hires in the School of Business, there is no more allocable space in Anderson Hall. This request would allow faculty to have dedicated offices and allow student better access.

The School of Business request for additional office space is due to new faculty hires, but also is related to staff hires. As the school continues to grow, space is limited in Olmsted and Anderson Hall. The school accurately planned for space for approved hires of three ladder rank and three adjunct positions. The school did not anticipate a new faculty starting this past January, nor a faculty member not leaving. The school also allocated an office to an HR analyst due to FERPA related work.

The offices in Olmsted will allow Business School faculty dedicated offices, better student access and increased visibility to our growing student population. The space is ideal since the School of Business has undergraduate academic affairs and advising on half the floor and graduate admissions and international relations on the other half. All efforts to engage students will be viewed positively by the students and increase learning outcomes.

Our school continues to grow and make an impact on the campus. We appreciate the committee's review and consideration on this space request.

## CHASS Justification

These rooms were assigned to CHASS in 2017. The space is being used as the following and was reconfirmed as listed below with the departments. We would like to continue these assignments as we have no other space to assign for these purposes.

2319 – Anthropology Lecture office. Shows two lecturers (Duong, Placentia). Lecturer usage confirmed with Anthropology

2321 – Was a Video Library office for a faculty member in Dance who retired this past year. This is now assigned as a TA space for Political Science because Dr. Kelechi Kalu is stepping down from his position and will be returning to the faculty in Political Science. The office they could provide Dr. Kalu is currently a TA office and they have no other space left in the department so the TAs are being located in this 2321 Olmsted Office. We are in the middle of preparing the office for the TA use.

2322 – Labor Studies Office (occupied by Ellen Reese from Sociology)

2320 – Anthropology Lecture office. Shows three lecturers in there (Gust, Hickey, Oh) Lecturer usage confirmed with Anthropology

Campus Space Requests and Proposed Targets - Updated 1/20/20

Target	Requirements / Notes	Date Requested	Status
School of Business	Business has requested 4 private offices in Olmsted. These offices are assigned to CHASS but are surrounded by Business offices.	1/6/2020	For discussion February USC meeting
Ombuds Office	Ombudsman has requested to move out of Skye Hall where they currently occupy 2 offices. They would like space near the center of campus, in a low traffic area with a discreet entrance out of sight of compliance and senior administrative offices. They would like a suite with a reception area, waiting area, 1-3 confidential offices, conference room for 10+, and an alternate exit for safety.	1/3/2020	On hold. No space identified.
Visualization Lab (Mobasher)	1,000 ASF for research, training, instruction and outreach. Unrestricted access, preferably close to the center of campus in a visible location. Newer infrastructure that can accommodate state of the art technology. Networked security cameras. Operating schedule 8-5 for training, instruction, outreach and 24/7 in support of research. Would be looking for grants to maintain and upgrade the space. Intended users: all colleges and centers, outreach programs, interdisciplinary online teaching. Supported through ITS with program development provided by research and academic programs. Requestor recommended spaces: Skye 0170, 0171, 0172 or 0173, CHASS Int South 1121 or 2138, CHASS Int North 1006. May not be feasible to take a general assignment classroom offline as requested.	9/24/2018	On hold. January 2020 update - CNAS and ITS have completed a MoU for a campus Visualization lab. ITS is assessing whether one of the remaining computer labs under their control could be used for this purpose.
Athletics Department	Athletics would like a space to use as a study hall since the one that is being utilized right now is for about 34 students and they have around 300 student athletes. They are requesting to have a space that increases their capacity from 34 seats to about 55-60 seats.	6/23/2019	On hold
CHASS / Psychology	Laboratory - Changes in research -- Need dry lab for Social Psychology in the department of Sociology. Occupant of Space: Rengin Farat	6/25/2019	On hold
CHASS / Latin American Studies	Other Research Office -Space needed for Center for Latin American Studies. Occupant of Space: Alfonso Gonzales	6/25/2019	On hold
CHASS / Center for Global Studies	Other Research Office - Space needed for the Center for Global Studies. Occupant of Space: Bronwyn Anne Leebaw	6/25/2019	On hold
CHASS / Political Science	Faculty Office - Need space for faculty offices to accommodate growth in the departments. Space needed: ASAP	6/25/2019	On hold
Compliance offices in Skye	Campus is transferring positions from HR to Compliance and they are requesting to co-locate the staff with other Compliance staff in Skye. They are looking for 3 private offices.	4/9/2019	On hold
Batchelor Hall	Space to accommodate 1/4 of the building in phases over a 2 year period (through 2022)	n/a	Information item only
NIH grant in Webber	Request to move forward with NIH construction grant submittal for the 2nd floor of Webber (SOM and BCOE collaboration). The request was approved by the Provost and If the grant is awarded, the space will be reassigned for this purpose. If not, the space will be available through the call letter process. Per David Lo, this will be reviewed June 26th and a few days later we should have a sense of where we stand. Actual approval would not be granted for several months.	2/7/2019	On hold. The grant was not approved for this year and will be resubmitted next year.
Shared human research studies space	Anticipated by departments as core space; large conference room; hoteling desks; various sizes testing rooms; 2,500 - 3,000 total asf; waiting area; office for staff. This was requested by a faculty member but there is not currently a plan to support this request.	11/15/2018	On hold
Business in Chapman	Need to match design/function of the buildings with users. Chapman may not appropriately accommodate wet lab research as currently assigned.	n/a	On hold
Relocate Chapman, Boyden, SPI faculty	Anticipate some reassignments from MRB and/or SOMR 1st floor released space	n/a	On hold
Reuse of Olmsted (Business released space)	If Olmsted is assigned space in Chapman, it is anticipated there would be released space in Olmsted to be reassigned	n/a	On hold

Campus Available /Anticipated Available Space - updated January 27, 2020

Building	Room(s)	ASF	GSF	Space Type - Current Use	Space Type - Design	Estimated Timeline	Current Occupant or Project providing released space	Temporary Use	Potential Long-Term Use	Condition
BIOLOGIC SCI	1107	125	192	ACAD OFF FACULTY		Winter 2020	Molecular, Cell & Systems Bio	Batchelor Hall		
BIOLOGIC SCI	1205	104	161	RSCH LABSV		Winter 2020	Molecular, Cell & Systems Bio	Batchelor Hall		
BIOLOGIC SCI	1205A	104	160	OCV		Winter 2020	Molecular, Cell & Systems Bio	Batchelor Hall		
BIOLOGIC SCI	1207	103	158	RSCH LABSV WET		Winter 2020	Molecular, Cell & Systems Bio	Batchelor Hall		
BIOLOGIC SCI	1215	105	162	RSCH LABSV WET		Winter 2020	Molecular, Cell & Systems Bio	Batchelor Hall		
BIOLOGIC SCI	2220	676	1,040	RESEARCH WET		Spring 2019	Molecular, Cell & Systems Bio	Batchelor Hall		
	<b>TOTAL ASF</b>	<b>1,217</b>	<b>1,873</b>							
CHEMICAL SCI	0221	667	1,026	RESEARCH WET		Winter 2020	CHEMISTRY	BATCHELOR HALL		
CHEMICAL SCI	0221A	326	502	RESEARCH DRY		Winter 2020	CHEMISTRY	BATCHELOR HALL		
CHEMICAL SCI	0223	668	1,028	RESEARCH WET		Winter 2020	CHEMISTRY	BATCHELOR HALL		
CHEMICAL SCI	0305	994	1,529	RESEARCH WET		Winter 2020	CHEMISTRY	BATCHELOR HALL		
CHEMICAL SCI	0339	996	1,532	RESEARCH WET		Winter 2020	CHEMISTRY	BATCHELOR HALL		
	<b>TOTAL ASF</b>	<b>3,651</b>	<b>5,617</b>							
GENOMICS	1207A	192	295	RESRCH OFC GRAD STUD		Summer 2019	Molecular, Cell & Systems Bio	Batchelor Hall	Potential use for IIGB new hire	
GENOMICS	1207H	141	217	OTHER OFF - HOTEL		Summer 2019	Molecular, Cell & Systems Bio	Batchelor Hall	Potential use for IIGB new hire	
GENOMICS	2112A	102	157	RSCH LABSV CONTROL TEMP		Spring 2019	Molecular, Cell & Systems Bio	Batchelor Hall	Potential use for IIGB new hire	
GENOMICS	2120	187	288	RSCH LABSV		Spring 2019	Molecular, Cell & Systems Bio	Batchelor Hall	Potential use for IIGB new hire	
GENOMICS	2120A	203	312	RSCH LABSV CONTROL TEMP		Spring 2019	Molecular, Cell & Systems Bio	Batchelor Hall	Potential use for IIGB new hire	
GENOMICS	2120B	137	211	RSCH LABSV CONTROL TEMP		Spring 2019	Molecular, Cell & Systems Bio	Batchelor Hall	Potential use for IIGB new hire	
GENOMICS	2121	168	258	OFFICE SRV INT HALLWAY		Spring 2019	Molecular, Cell & Systems Bio	Batchelor Hall	Potential use for IIGB new hire	
GENOMICS	2121B	171	263	ACAD OFF FACULTY		Spring 2019	Molecular, Cell & Systems Bio	Batchelor Hall	Potential use for IIGB new hire	
GENOMICS	2122	100	154	RSCH LABSV WET		Spring 2019	Molecular, Cell & Systems Bio	Batchelor Hall	Potential use for IIGB new hire	
GENOMICS	2124	94	145	RSCH LABSV WET		Spring 2019	Molecular, Cell & Systems Bio	Batchelor Hall	Potential use for IIGB new hire	
GENOMICS	2126	3,183	4,897	RESEARCH WET		Spring 2019	Molecular, Cell & Systems Bio	Batchelor Hall	Potential use for IIGB new hire	
	<b>TOTAL ASF</b>	<b>4,678</b>	<b>7,197</b>							
Life Science	0438	586	902	RESEARCH WET		Spring 2020	Psychology	Batchelor Hall		
Pierce	3424	702	1,080	ALTERATION		Spring 2020	Pierce Hall Renovation, Ph 1	Batchelor Hall	RESEARCH WET	
Pierce	3424A	141	217	ALTERATION		Spring 2020	Pierce Hall Renovation, Ph 1	Batchelor Hall	RSCH LABSV	
Pierce	3424B	37	57	ALTERATION		Spring 2020	Pierce Hall Renovation, Ph 1	Batchelor Hall	RSCH LABSV	
Pierce	3428	122	188	ALTERATION		Spring 2020	Pierce Hall Renovation, Ph 1	Batchelor Hall	ACAD OFF FACULTY	
	<b>TOTAL ASF</b>	<b>1002</b>	<b>1,542</b>							
STUDENT SERVICES	3250	135	208	OTHER OFF (3 CUBICLES)		Available	Reconfiguration of AVC Enrollment space		<b>Note: 1 cubicle temporary use for Pierce Hall medical accommodation</b>	
WEBBER	1235	38	58	RSCH LABSV		Available	SOM	Batchelor Hall	Chapman/Boyden/SPI	
WEBBER	1235A	112	172	RSCH LABSV WET		Available	SOM	Batchelor Hall	Chapman/Boyden/SPI	
WEBBER	1237	154	237	ACAD OFF FACULTY		Available	SOM	Batchelor Hall	Chapman/Boyden/SPI	
WEBBER	1248	677	1,042	RESEARCH WET		Available	SOM	Batchelor Hall	Chapman/Boyden/SPI	
WEBBER	1252	319	491	RSCH LABSV WET		Available	SOM	Batchelor Hall	Chapman/Boyden/SPI	
WEBBER	1254	249	383	OTHER OFF		Available	SOM	Batchelor Hall	Chapman/Boyden/SPI	
WEBBER	1317	1053	1,619	RESEARCH WET		Available	SOM	Batchelor Hall	Chapman/Boyden/SPI	
WEBBER	1317A	38	58	RSCH LABSV EQUIPMENT		Available	SOM	Batchelor Hall	Chapman/Boyden/SPI	
WEBBER	1317B	124	191	RSCH LABSV WET		Available	SOM	Batchelor Hall	Chapman/Boyden/SPI	
WEBBER	1317C	81	125	RSCH LABSV DARK ROOM		Available	SOM	Batchelor Hall	Chapman/Boyden/SPI	
Webber	2101	617	949	RSCH LABSV WET		Available	SOM	Batchelor Hall	Potential NIH grant or Chapman/Boyden/SPI relocations	
Webber	2101A	162	249	RESRCH OFC RESEARCH STAFF		Available	SOM	Batchelor Hall	Potential NIH grant or Chapman/Boyden/SPI relocations	
Webber	2101B	163	250	RSCH LABSV WET		Available	SOM	Batchelor Hall	Potential NIH grant or Chapman/Boyden/SPI relocations	
Webber	2101C	340	523	RESEARCH WET		Available	SOM	Batchelor Hall	Potential NIH grant or Chapman/Boyden/SPI relocations	
Webber	2139	223	342	RESEARCH INSTRUMENT		Available	SOM	Batchelor Hall	Potential NIH grant or Chapman/Boyden/SPI relocations	
Webber	2140	567	872	RESEARCH		Available	SOM	Batchelor Hall	Potential NIH grant or Chapman/Boyden/SPI relocations	
Webber	2146	153	235	ACAD OFF FACULTY		Available	SOM	Batchelor Hall	Potential NIH grant or Chapman/Boyden/SPI relocations	
Webber	2219	184	283	RESEARCH WET		Available	SOM	Batchelor Hall	Potential NIH grant or Chapman/Boyden/SPI relocations	
Webber	2226	465	715	RESEARCH WET		Available	SOM	Batchelor Hall	Potential NIH grant or Chapman/Boyden/SPI relocations	

Campus Available /Anticipated Available Space - updated January 27, 2020

Building	Room(s)	ASF	GSF	Space Type - Current Use	Space Type - Design	Estimated Timeline	Current Occupant or Project providing released space	Temporary Use	Potential Long-Term Use	Condition
Webber	2226A	145	223	ACAD OFF FACULTY		Available	SOM	Batchelor Hall	Potential NIH grant or Chapman/Boyden/SPI relocations	
WEBBER	2231	226	348	RESEARCH WET		Available	SOM	Batchelor Hall	Potential NIH grant or Chapman/Boyden/SPI relocations	
Webber	2235	158	243	RSCH LABSV		Available	SOM	Batchelor Hall	Potential NIH grant or Chapman/Boyden/SPI relocations	
WEBBER	2241	144	222	RESEARCH INSTRUMENT		Available	SOM	Batchelor Hall	Potential NIH grant or Chapman/Boyden/SPI relocations	
WEBBER	2245	39	60	RESEARCH INSTRUMENT		Available	SOM	Batchelor Hall	Potential NIH grant or Chapman/Boyden/SPI relocations	
WEBBER	2245A	111	171	RESEARCH INSTRUMENT		Available	SOM	Batchelor Hall	Potential NIH grant or Chapman/Boyden/SPI relocations	
WEBBER	2247	152	234	RSCH LABSV WET		Available	SOM	Batchelor Hall	Potential NIH grant or Chapman/Boyden/SPI relocations	
WEBBER	2263	449	691	RESEARCH WET		Available	SOM	Batchelor Hall	Potential NIH grant or Chapman/Boyden/SPI relocations	
WEBBER	2269	154	236	ACAD OFF FACULTY		Available	SOM	Batchelor Hall	Potential NIH grant or Chapman/Boyden/SPI relocations	
WEBBER	3220	2332	3,588	RESEARCH		Available	Microbiology & Plant Pathology	Batchelor Hall	Chapman/Boyden/SPI relocation	
WEBBER	3263	133	204	ACAD OFF FACULTY		Available	Microbiology & Plant Pathology	Batchelor Hall	Chapman/Boyden/SPI relocation	
	<b>TOTAL ASF</b>	<b>9,758</b>	15,012							
	<b>GRAND TOTAL</b>	<b>21,027</b>	<b>32,350</b>							